

Parker Ball Valves With Quad Piston Actuators

A compact solution for those areas where space is a premium.



Parker Ball Valves with a quarter turn “rack & pinion” pneumatic actuator

Parker Ball Valves provide quick ¼ turn control of fluids utilized in process and instrumentation applications

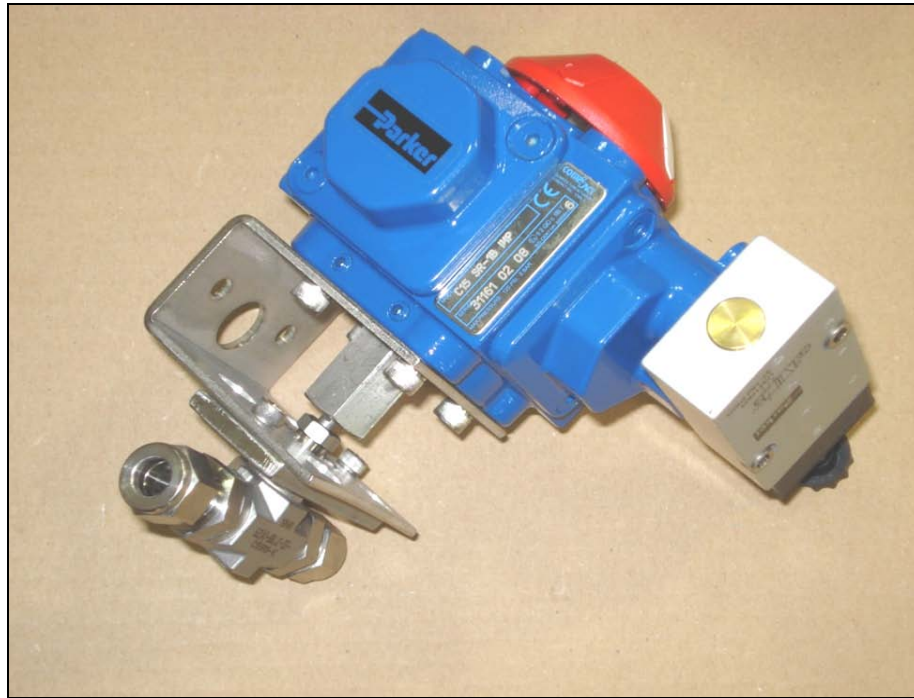

Contact Information:

Parker Hannifin Corporation
Instrumentation Products Division
1005 A Cleaner Way
Huntsville, AL 35805

phone 256.881.2040
fax 256.881.5730
ipdsales@parker.com

www.parker.com/ipdus



Product Features:

- Four cylinders and a central pinion design
- Compact design
- Cube shape...no excess space requirements
- Design of forced balanced pistons
- Visible, adjustable actuator indicator

Product Benefits:

- Excellent torque vs other single or double rack and pinion designs
- Fast acting travel in a small footprint.
- Minimum air consumption
- Prevents uneven wear of o-rings, gears, and pistons....longer life.
- Ability to use “snap on “ arrows to allow true positioning for any type of ball porting.

ENGINEERING YOUR SUCCESS.

PNEUMATIC ACTUATORS: 50 SERIES
RECOMMENDED ACTUATORS

Valve Series	Double Acting AD	Spring Return AO	Spring Return AC
B2LJ	51AD	51AO	51AC
B2LJ2	51AD	51AO	51AC
B2XJ	51ADX	51AOX	51ACX
B2XJ2	51ADX	51AOX	51ACX
B6LJ	51AD	51AO	51AC
B6LJ2	51AD	51AO	51AC
B6LS2	51AD	51AO	51AC
B6LPKR	51AD	51AO	51AC
B6LSPKR	51AD	51AO	51AC
B6XJ	51ADX	51AOX	51ACX
B6XJ2	51ADX	51AOX	51ACX
B6XS2	51ADX	51AOX	51ACX
B6XPKR	51ADX	51AOX	51ACX
B6XSPKR	51ADX	51AOX	51ACX
B8LJ	51AD	51AO	51AC
B8LJ2	51AD	52AO	52AC
B8LS2	51AD	52AO	52AC
B8LPKR	51AD	52AO	52AC
B8LSPKR*	51AD	52AO	52AC
B8XJ	51ADX	51AOX	51ACX
B8XJ2	51ADX	53AOX	53ACX
B8XS2	51ADX	53AOX	53ACX
B8XPKR	51ADX	53AOX	53ACX
B8XSPKR*	51ADX	53AOX	53ACX
HB4LPKR	52AD	52AO	52AC
HB4LK	51AD	51AO	51AC
HB4XPKR	51ADX	52AO	52AC
HB4XK	51ADX	51AOX	51ACX
MB2A	51AD	51AO	51AC
MB2L	51AD	51AO	51AC
MB2X	51ADX	51AOX	51ACX
MB4A	51AD	51AO	51AC
MB4L	51AD	51AO	51AC
MB4X	51ADX	51AOX	51ACX
MB6A	51AD	51AO	51AC
MB6L	51AD	51AO	51AC
MB6X	51ADX	51AOX	51ACX
SWB4	51AD	51AO	51AC
SWB8	51AD	52AO	52AC
SWB12	51AD	52AO	52AC
SWB16	52AD	53AO	53AC

* NOT IN CURRENT CATALOG FOR 61 SERIES

Dimensional Reference

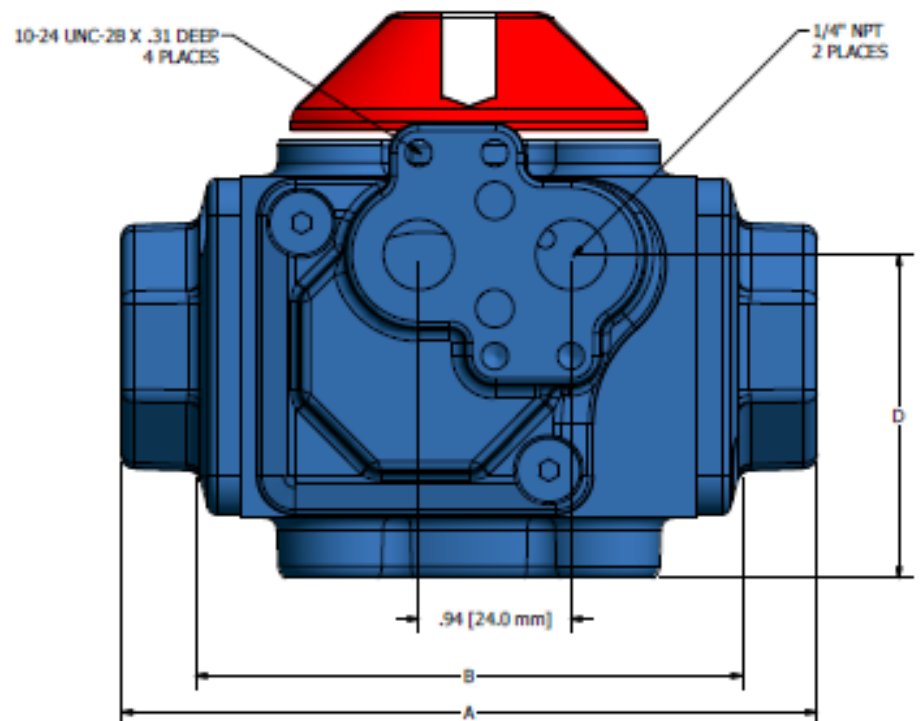
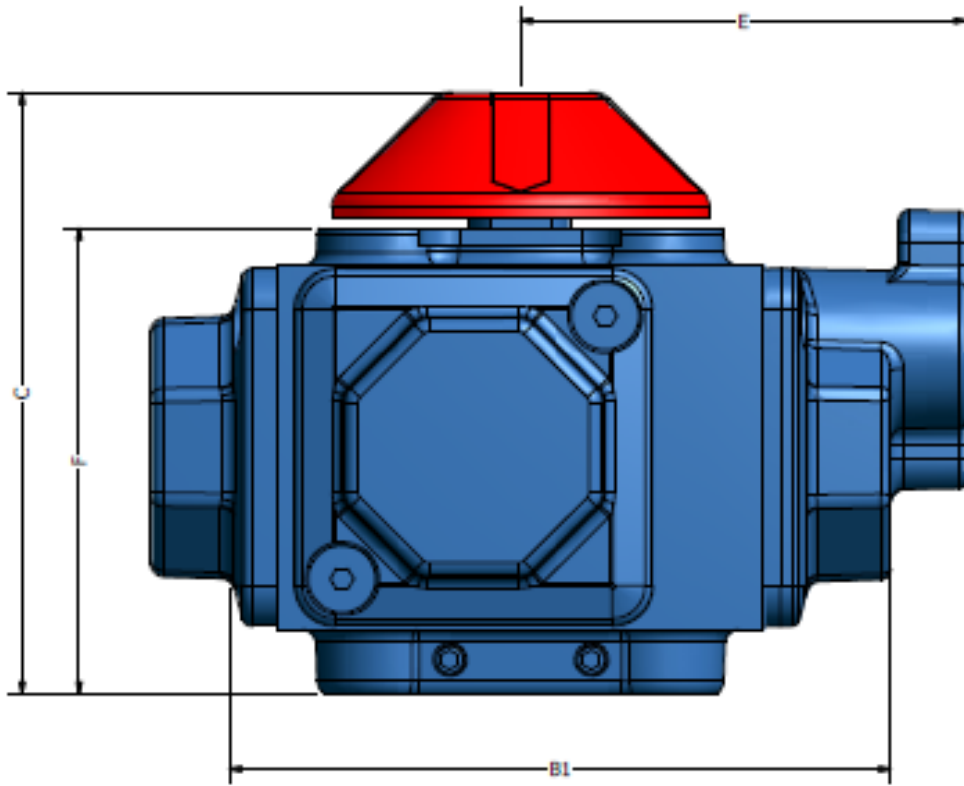

Dimensional Data

Model	A		B		B1		C		D		E		F	
	Inch	mm	Inch	mm	Inch	mm	Inch	mm	Inch	mm	Inch	mm	Inch	mm
51AD	-	-	3.39	86	3.85	97.8	3.50	88.8	2.00	50.8	2.60	66.0	2.71	68.8
51AC/AO	4.31	110	-	-	-	-	3.50	88.8	2.00	50.8	2.60	66.0	2.71	68.8
52AD	-	-	4.03	102	4.6	117	3.96	100.5	2.42	61.5	3.04	77.2	3.17	80.5
52AC/AO	5.17	131	-	-	-	-	3.96	100.5	2.42	61.5	3.04	77.2	3.17	80.5
53AC/AO	6.34	161	-	-	-	-	4.61	117.0	3.01	76.5	3.54	90.0	3.82	97.0
54AC/AO	7.33	186	-	-	-	-	5.35	136	3.68	93.4	4.15	105	4.58	116

Performance Characteristics

Series	Weight				Operating Time*	Air Consumption		Air Consumption	
	AD		AC/AO			in ³		cc	
	lb	kg	Lb	kg		Port "A"	Port "B"+	Port "A"	Port "B"+
51	1.98	0.9	2.4	1.1	0.15	4.3	5.5	70	90
52	3.2	1.5	4.2	1.9	0.15	7.3	9.2	120	150
53	-	-	7.7	3.5	0.23	15	-	250	-
54	-	-	11	5	0.29	27	-	440	-

*80 psig actuation air

+Double acting only

AD Torques

Series	40 psi (2.8 bar)		60 psi (4.1 bar)		80 psi (5.5bar)		100 psi (6.9 bar)		120 psi (8.3 bar)	
	in-lb	N-m	in-lb	N-m	in-lb	N-m	in-lb	N-m	in-lb	N-m
51	81	9.1	125	14.1	172	19.4	207	23.4	244	27.6
52	146	16.5	229	25.9	311	35.1	390	44.1	468	52.9

AC and AO Torques

Series	Air Torque								Spring Torque	
	60 psi (4.1 bar)		80 psi (5.5bar)		100 psi (6.9 bar)		120 psi (8.3 bar)			
	in-lb	N-m	in-lb	N-m	in-lb	N-m	in-lb	N-m	in-lb	N-m
51	40	4.5	86	9.7	123	13.9	161	18.2	44	5.0
52	62	7.0	145	16.4	223	25.2	291	32.9	97	11.0
53	178	20.1	343	38.7	505	57.1	644	72.8	159	18.0
54	165	18.6	482	54.5	762	86.1	1002	113.2	319	36.0